



Frontier Electronics Corp.

685 E. COCHRAN STREET, SIMI VALLEY, CA 93065

TEL: (805) 522-9998 FAX: (805) 522-9989

E-mail: frontiersales@frontierusa.com

Web: frontierusa.com

SMD Power Choke—CSH1560SR series

A. Electrical specifications:

Part No.	Marking	L (uH) $\pm 30\%$	Test Freq.	DCR (m Ω max.)	I rms. (A)
CSH1560SR-0R5M	0R5	0.5	100KHz	1.2	38
CSH1560SR-1R0M	1R0	1.0	100KHz	2.0	27

B. Mechanical dimensions: (Unit: mm)

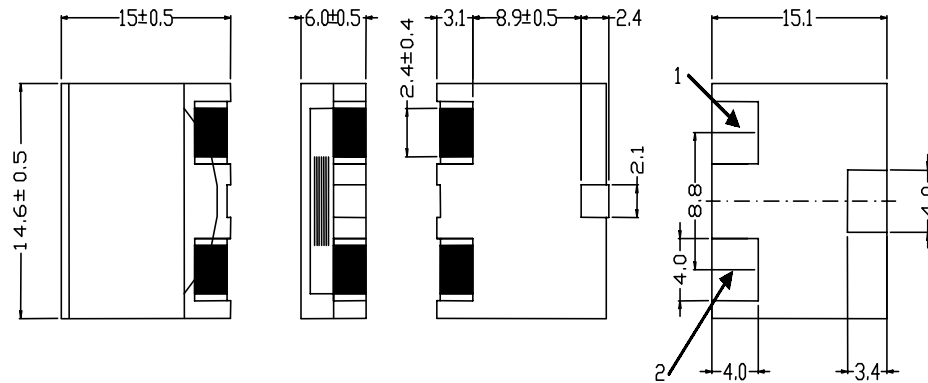

Mechanic Dimension

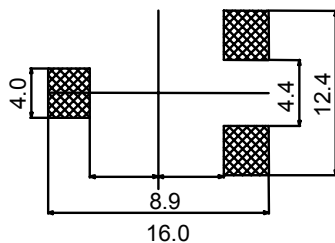

Land pattern

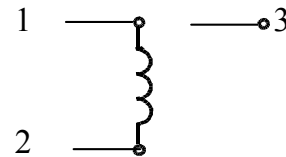

Schematics

C. Features:

1. Tolerance: M: $\pm 20\%$.
2. Operating temperature: -25°C TO $+100^{\circ}\text{C}$.
3. Inductance measured on the HP4284A LCR meter.
4. DCR measured on the 502BC milli-ohm meter.
5. Inductance drops no more than 25% at rated current applied or temperature increases $\Delta t < 40^{\circ}\text{C}$.
6. Flat stack wire wound perpendicular to the center of the core.
7. Inductance and Current range:
 - a.) CSS1250S: From 0.5uH(38.0A) to 1.0uH(27.0A).



Frontier Electronics Corp.

685 E. COCHRAN STREET, SIMI VALLEY, CA 93065

TEL: (805) 522-9998 FAX: (805) 522-9989

E-mail: frontiersales@frontierusa.com

Web: frontierusa.com

SMD Power Choke—CSH1560SR series

D. Characteristic curve:

1. L vs. Frequency:

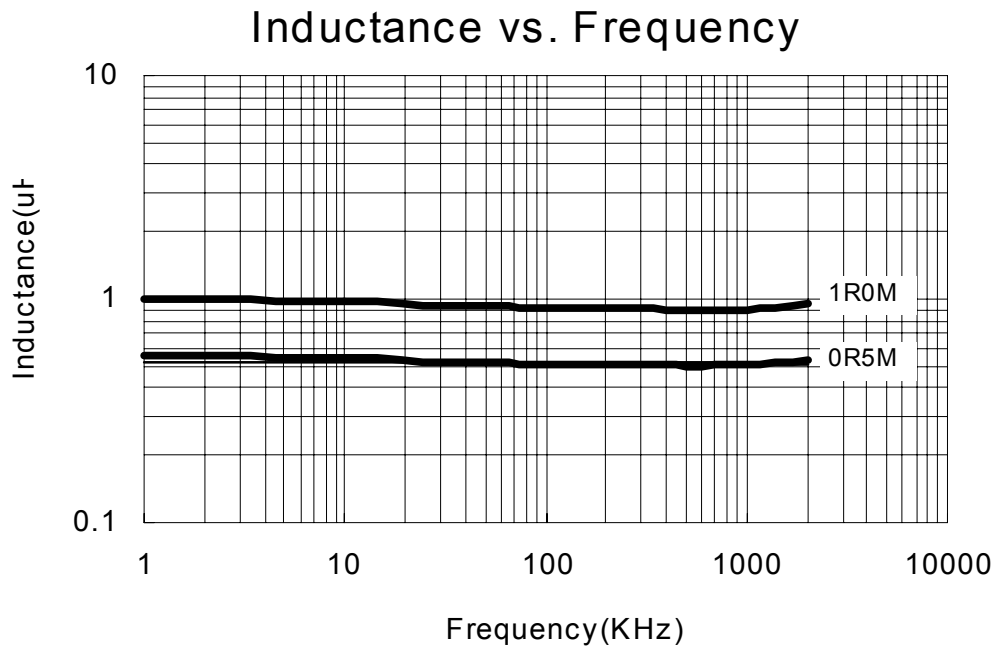

2. Typical L vs. DC Current:

