



Frontier Electronics Corp.

667 E. COCHRAN STREET, SIMI VALLEY, CA 93065
 TEL: (805) 522-9998 FAX: (805) 522-9989
 E-mail: frontiersales@frontierusa.com
 Web: frontierusa.com

SMD Power Choke—CSS0428P series

A. Electrical specification:

Part No.	Mark	L (uH) ± 30%	Test Freq.	DCR Max. (mΩ)	I rms. (A)
CSS0428P-1R2N	1R2	1.2 uH	100KHz	23.6	2.56
CSS0428P-1R8N	1R8	1.8 uH	100KHz	27.5	2.20
CSS0428P-2R2N	2R2	2.2 uH	100KHz	31.3	2.04
CSS0428P-2R7N	2R7	2.7 uH	100KHz	43.3	1.60
CSS0428P-3R3N	3R3	3.3 uH	100KHz	49.2	1.57
CSS0428P-3R9N	3R9	3.9 uH	100KHz	64.8	1.44
CSS0428P-4R7N	4R7	4.7 uH	100KHz	72.0	1.32
CSS0428P-5R6N	5R6	5.6 uH	100KHz	100.9	1.17
CSS0428P-6R8N	6R8	6.8 uH	100KHz	108.9	1.12
CSS0428P-8R2N	8R2	8.2 uH	100KHz	117.5	1.04
CSS0428P-100N	100	10 uH	100KHz	128.3	1.00
CSS0428P-120N	120	12 uH	100KHz	131.6	0.84
CSS0428P-150N	150	15 uH	100KHz	149.0	0.76
CSS0428P-180N	180	18 uH	100KHz	166.0	0.72
CSS0428P-220N	220	22uH	100KHz	235.0	0.70
CSS0428P-270N	270	27 uH	100KHz	261.0	0.58
CSS0428P-330N	330	33 uH	100KHz	331.3	0.56
CSS0428P-390N	390	39 uH	100KHz	383.7	0.50
CSS0428P-470N	470	47 uH	100KHz	587.0	0.48
CSS0428P-560N	560	56 uH	100KHz	624.5	0.41
CSS0428P-680N	680	68 uH	100KHz	699.0	0.35
CSS0428P-820N	820	82uH	100KHz	914.8	0.32
CSS0428P-101N	101	100uH	100KHz	1020.0	0.29
CSS0428P-121N	121	120uH	100KHz	1270.0	0.27
CSS0428P-151N	151	150uH	100KHz	1350.0	0.24
CSS0428P-181N	181	180uH	100KHz	1700.0	0.22

B. Mechanical dimensions: (Unit: mm.)

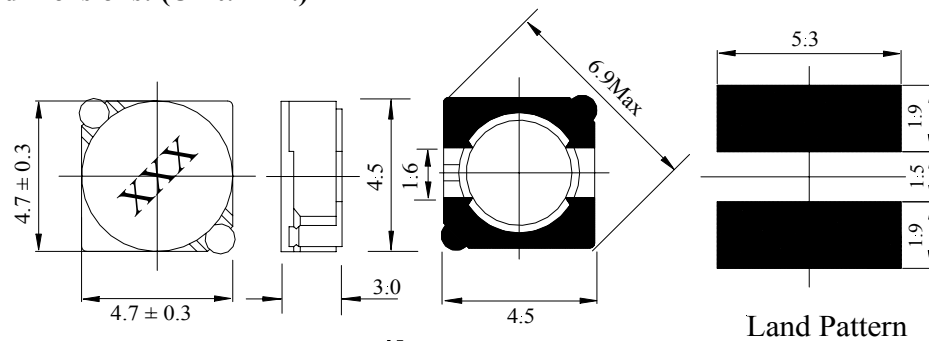

□ Electrode
Type 2: Shielded

C. Features:

1. Tolerance: N: ± 30%, M: ± 20%.
2. Operating temperature: -40°C TO +100°C.
3. Inductance measured on the HP4284A LCR meter.
4. DCR measured on the 502BC milli-ohm meter.
5. Inductance drops no more than 35% at rated current applied or temperature rise $\Delta t < 40^\circ\text{C}$.
6. Inductance and Current range:
 - a.) CSS0428P: From 1.20 uH (2.56 A) to 180 uH (220 mA).

Note: RoHS compliant; for the ROHS parts, we add “-LFR” at the end of the P/N.



Frontier Electronics Corp.

667 E. COCHRAN STREET, SIMI VALLEY, CA 93065

TEL: (805) 522-9998 FAX: (805) 522-9989

E-mail: frontiersales@frontierusa.com

Web: frontierusa.com

SMD Power Choke—CSS0428P series

D. Characteristic curve:

1. L vs. Frequency:

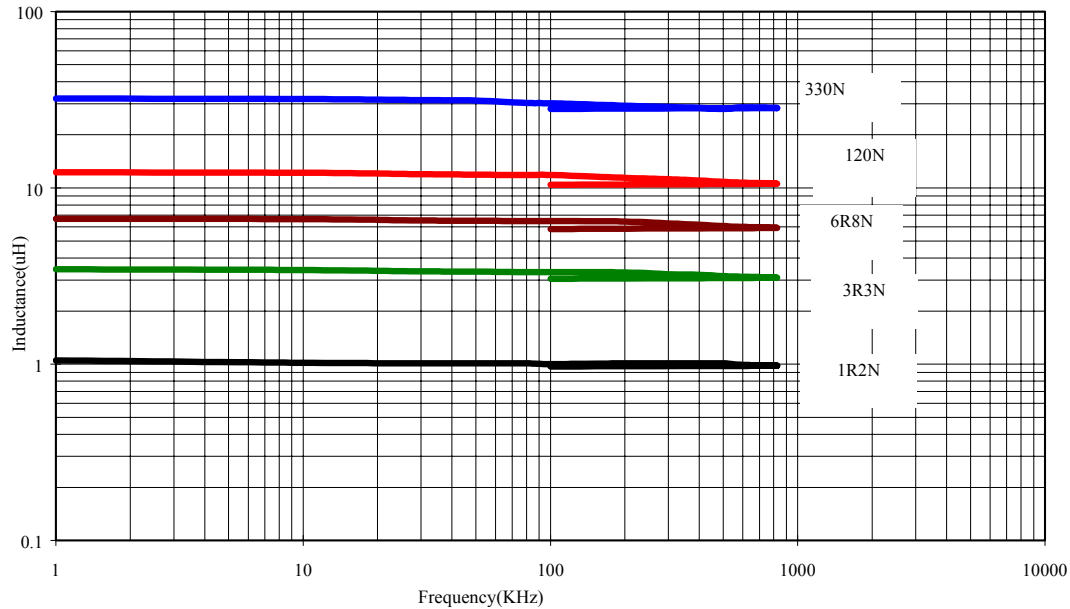

2. Typical L vs. DC Current:

