



Frontier Electronics Corp.

667 E. COCHRAN STREET, SIMI VALLEY, CA 93065

TEL: (805) 522-9998 FAX: (805) 522-9989

E-mail: frontiersales@frontierusa.com

Web: frontierusa.com

SMD Power Choke—CSS0528P series

A. Electrical specifications:

Part No.	Mark	L (uH) ± 30%	Test Freq.	DCR (max) (mΩ)	I rms. (A)
CSS0528P-2R5N	2R5	2.5	10KHz	18	2.60
CSS0528P-3R0N	3R0	3.0	10KHz	24	2.40
CSS0528P-4R2N	4R2	4.2	10KHz	31	2.20
CSS0528P-5R3N	5R3	5.3	10KHz	38	1.90
CSS0528P-6R2N	6R2	6.2	10KHz	45	1.80
CSS0528P-8R2N	8R2	8.2	10KHz	53	1.60
CSS0528P-100N	100	10	10KHz	65	1.30
CSS0528P-120N	120	12	10KHz	76	1.20
CSS0528P-150N	150	15	10KHz	103	1.10
CSS0528P-180N	180	18	10KHz	110	1.00
CSS0528P-220N	220	22	10KHz	122	0.90
CSS0528P-270N	270	27	10KHz	175	0.85
CSS0528P-330N	330	33	10KHz	189	0.75
CSS0528P-390N	390	39	10KHz	212	0.70
CSS0528P-470N	470	47	10KHz	250	0.62
CSS0528P-560N	560	56	10KHz	305	0.58
CSS0528P-680N	680	68	10KHz	355	0.52
CSS0528P-820N	820	82	10KHz	463	0.46
CSS0528P-101N	101	100	10KHz	520	0.42

B. Mechanical dimensions: (Unit: mm)

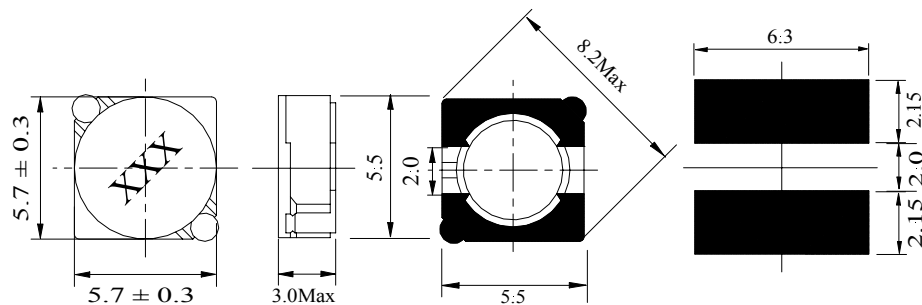

Electrode

Land Pattern

Type 2: Shielded

C. Features:

1. Tolerance: N: ± 30%, M: ± 20%, L: ± 15%, K: ± 10%.
2. Operating temperature: -40°C to +85°C.
3. Inductance measured on the HP4284A LCR meter.
4. DCR measured on the 502BC milli-ohm meter.
5. Inductance drops no more than 35% at rated current applied or temperature rise $\Delta t < 30^\circ\text{C}$.
6. Inductance and Current range:
 - a.) CSS0528P-series: From 2.50μH (2.60A) to 100μH (0.42A).

Note: RoHS compliant; for the ROHS parts, we add “-LFR” at the end of the P/N.



Frontier Electronics Corp.

667 E. COCHRAN STREET, SIMI VALLEY, CA 93065
TEL: (805) 522-9998 FAX: (805) 522-9989
E-mail: frontiersales@frontierusa.com
Web: frontierusa.com

SMD Power Choke—CSS0528P series

D. Characteristic curve:

1. L vs. Frequency:

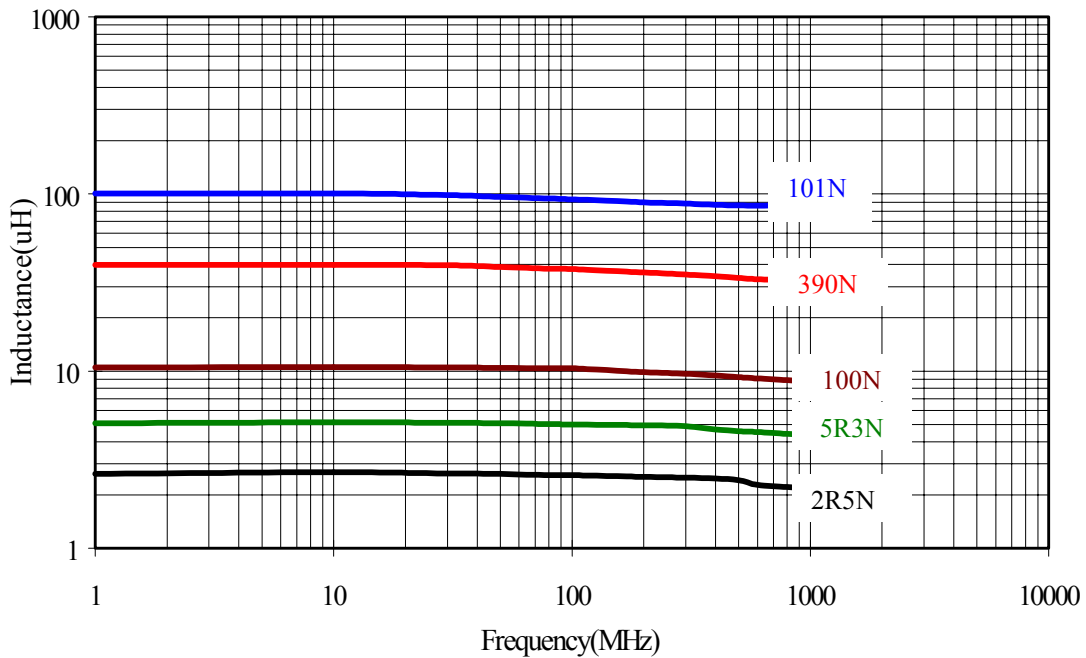

2. Typical L vs. DC Current:

