



Frontier Electronics Corp.®

667 E. COCHRAN STREET, SIMI VALLEY, CA 93065

TEL: (805) 522-9998 FAX: (805) 522-9989

E-mail: frontiersales@frontierusa.com

Web: <http://www.frontierusa.com>

SMD Power Choke—CSS127P-xxxx-LFR

A. Electrical specification:

Part No.	Mark	L (uH)	Test Freq.	DCR max. (Ω)	I rms. (A)
CSS127P-1R2N-LFR	1R2	1.2 +40%, -20%	100 KHz	0.0070	9.80
CSS127P-2R4N-LFR	2R4	2.4 +40%, -20%	100 KHz	0.0115	8.00
CSS127P-3R5N-LFR	3R5	3.5 +40%, -20%	100 KHz	0.0135	7.50
CSS127P-4R7N-LFR	4R7	4.7 +40%, -20%	100 KHz	0.0158	6.80
CSS127P-6R1N-LFR	6R1	6.1 +40%, -20%	100 KHz	0.0176	6.60
CSS127P-7R6N-LFR	7R6	7.6 +40%, -20%	100 KHz	0.0200	5.90
CSS127P-100M-LFR	100	10 ±20%	1 KHz	0.0216	5.40
CSS127P-120M-LFR	120	12 ±20%	1 KHz	0.0243	4.90
CSS127P-150M-LFR	150	15 ±20%	1 KHz	0.0270	4.50
CSS127P-180M-LFR	180	18 ±20%	1 KHz	0.0392	3.90
CSS127P-220M-LFR	220	22 ±20%	1 KHz	0.0432	3.60
CSS127P-270M-LFR	270	27 ±20%	1 KHz	0.0459	3.40
CSS127P-330M-LFR	330	33 ±20%	1 KHz	0.0648	3.00
CSS127P-390M-LFR	390	39 ±20%	1 KHz	0.0729	2.75
CSS127P-470M-LFR	470	47 ±20%	1 KHz	0.1000	2.50
CSS127P-560M-LFR	560	56 ±20%	1 KHz	0.11	2.35
CSS127P-680M-LFR	680	68 ±20%	1 KHz	0.14	2.10
CSS127P-820M-LFR	820	82 ±20%	1 KHz	0.16	1.95
CSS127P-101M-LFR	101	100 ±20%	1 KHz	0.22	1.70
CSS127P-121M-LFR	121	120 ±20%	1 KHz	0.25	1.60
CSS127P-151M-LFR	151	150 ±20%	1 KHz	0.28	1.42
CSS127P-181M-LFR	181	180 ±20%	1 KHz	0.35	1.30
CSS127P-221M-LFR	221	220 ±20%	1 KHz	0.39	1.16
CSS127P-271M-LFR	271	270 ±20%	1 KHz	0.56	1.06
CSS127P-331M-LFR	331	330 ±20%	1 KHz	0.64	0.95
CSS127P-391M-LFR	391	390 ±20%	1 KHz	0.70	0.88
CSS127P-471M-LFR	471	470 ±20%	1 KHz	0.98	0.79
CSS127P-561M-LFR	561	560 ±20%	1 KHz	1.07	0.73
CSS127P-681M-LFR	681	680 ±20%	1 KHz	1.46	0.67
CSS127P-821M-LFR	821	820 ±20%	1 KHz	1.64	0.60
CSS127P-102M-LFR	102	1000 ±20%	1 KHz	1.82	0.55
CSS127P-152M-LFR	152	1500 ±20%	1 KHz	2.52	0.20

B. Mechanical dimensions: (Unit: mm.)

SERIES	A	B	C	D	E	F	G	H	Type
CSS127P	12.0 ± 0.3	12.0 ± 0.3	8.0(MAX)	5.0	8.4	5.4	2.8	7	1

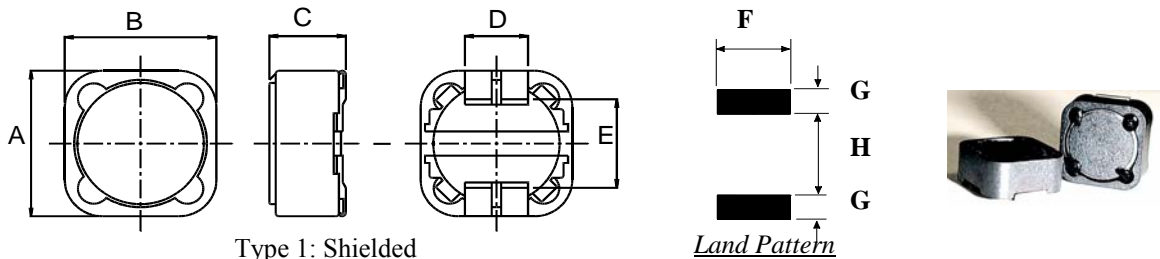

Type 1: Shielded

Land Pattern

C. Features:

- Tolerance: M: ± 20%, L: ± 15%, K: ± 10%.
- Operating temperature: -25°C TO +85°C.
- Inductance measured on the HP4284A LCR meter & DCR measured on the 502BC milli-ohm meter.
- Inductance drops no more than 25% at rated current applied or temperature rise $\Delta t < 40^\circ\text{C}$.
- Inductance and Current range: CSS127P-series: From 1.20 uH (9.80 A) to 1000 uH (0.55 A)
- **RoHS Compliant.**



Frontier Electronics Corp.®

667 E. COCHRAN STREET, SIMI VALLEY, CA 93065

TEL: (805) 522-9998 FAX: (805) 522-9989

E-mail: frontiersales@frontierusa.com

Web: <http://www.frontierusa.com>

SMD Power Choke—CSS127P-xxxx-LFR

D. Characteristic curve:

1. L vs. Frequency:

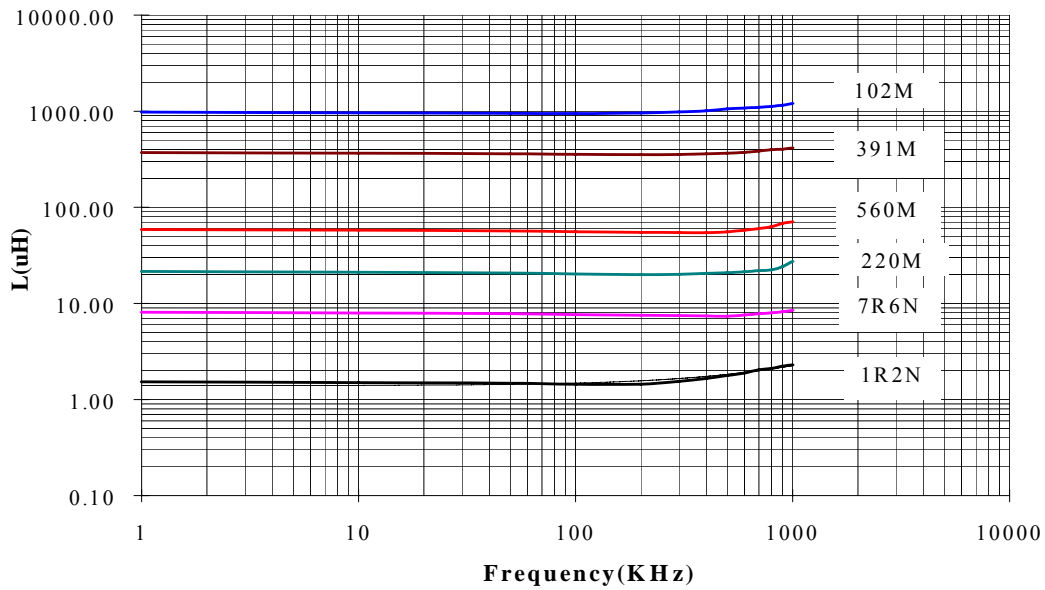

2. Typical L vs. DC Current:

